

7.1.4 Water conservation facilities

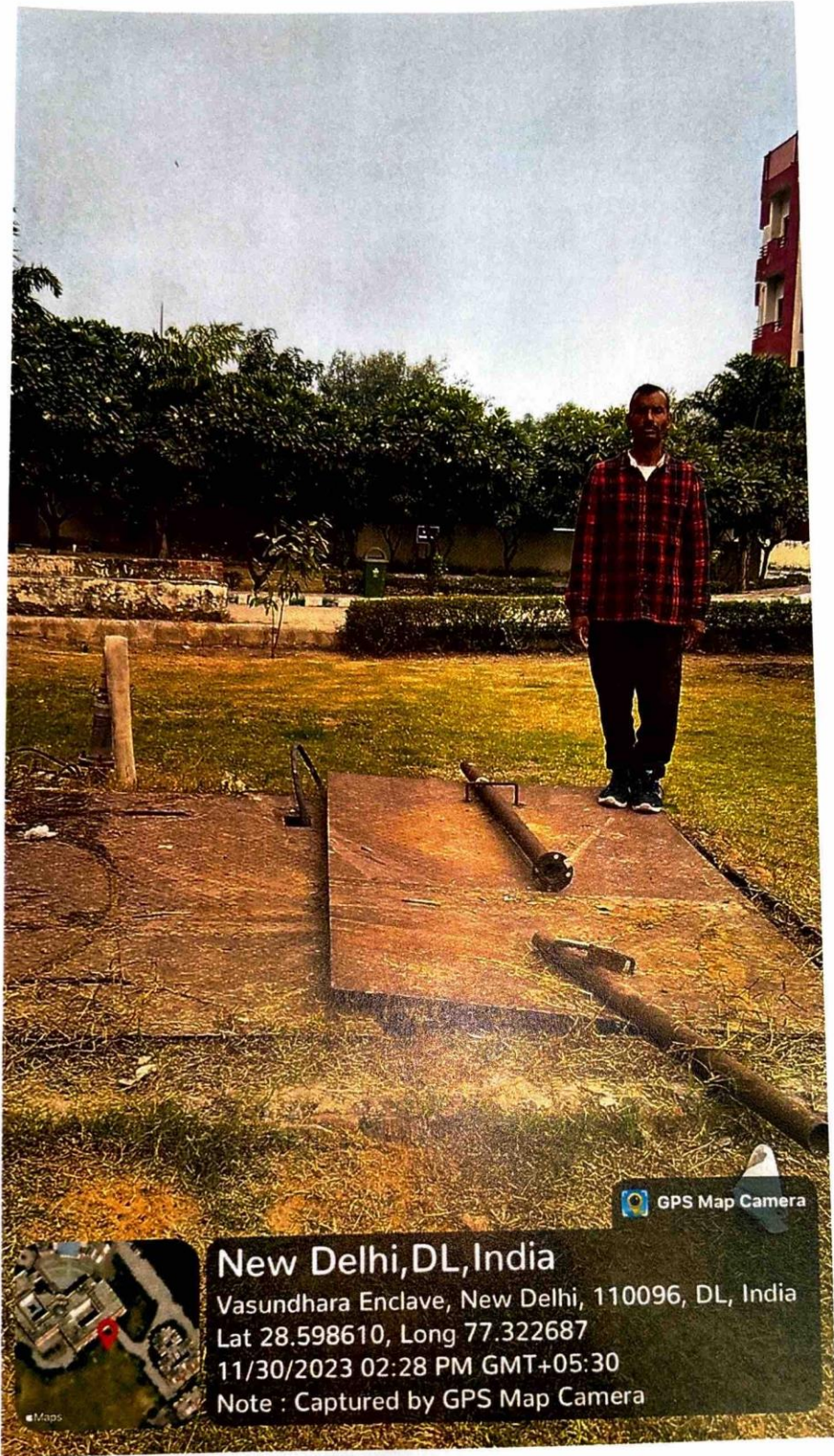

Rainwater harvesting pits



Tanks for storing water



GPS Map Camera

New Delhi, DL, India

Bhagwan Mahavir Swami Marg, Vasundhara
Enclave, New Delhi, 110096, DL, India

Lat 28.599518, Long 77.322230

11/30/2023 12:33 PM GMT+05:30

Note : Captured by GPS Map Camera

Pits ensuring water distribution and circulation

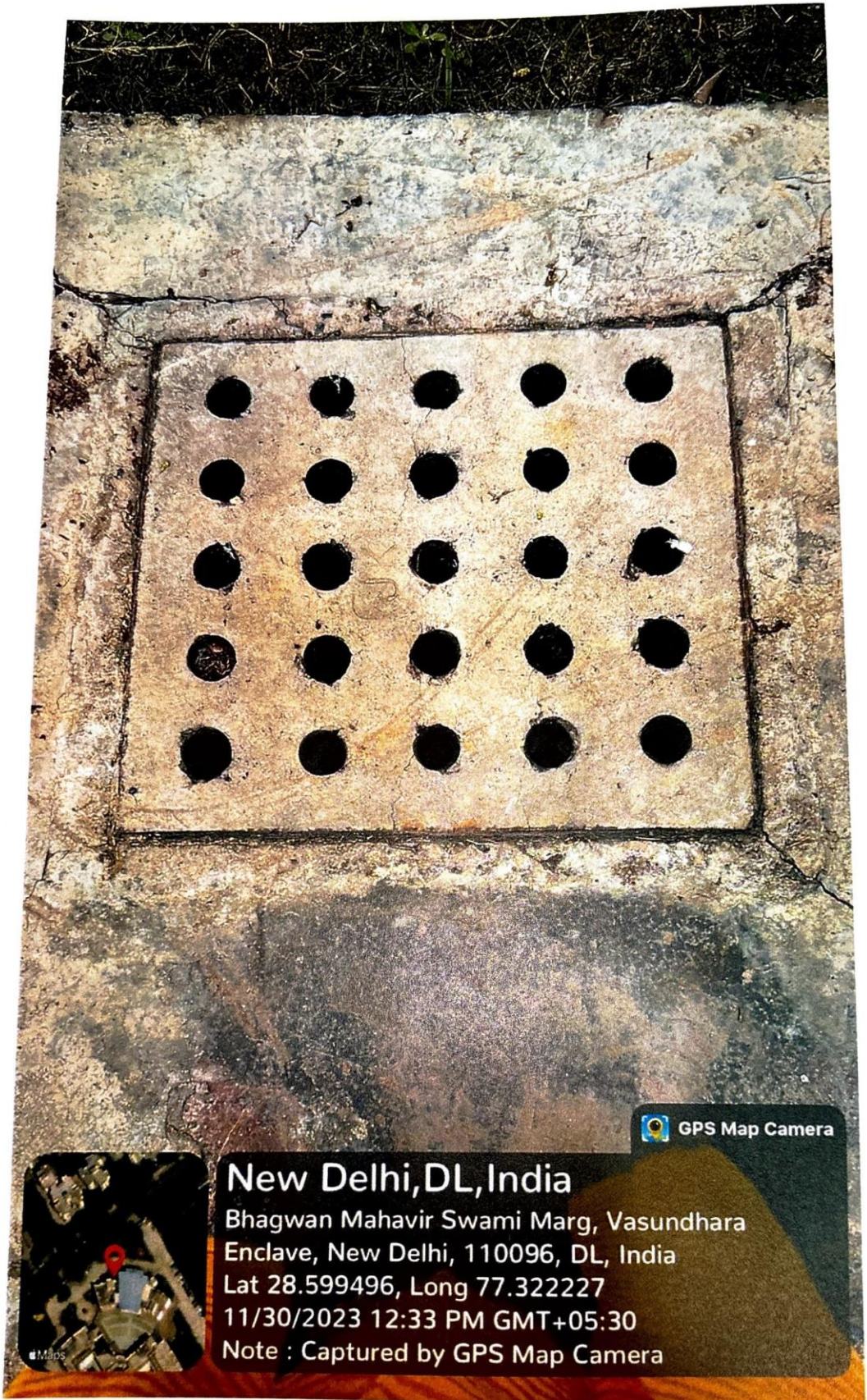

Water harvesting systems

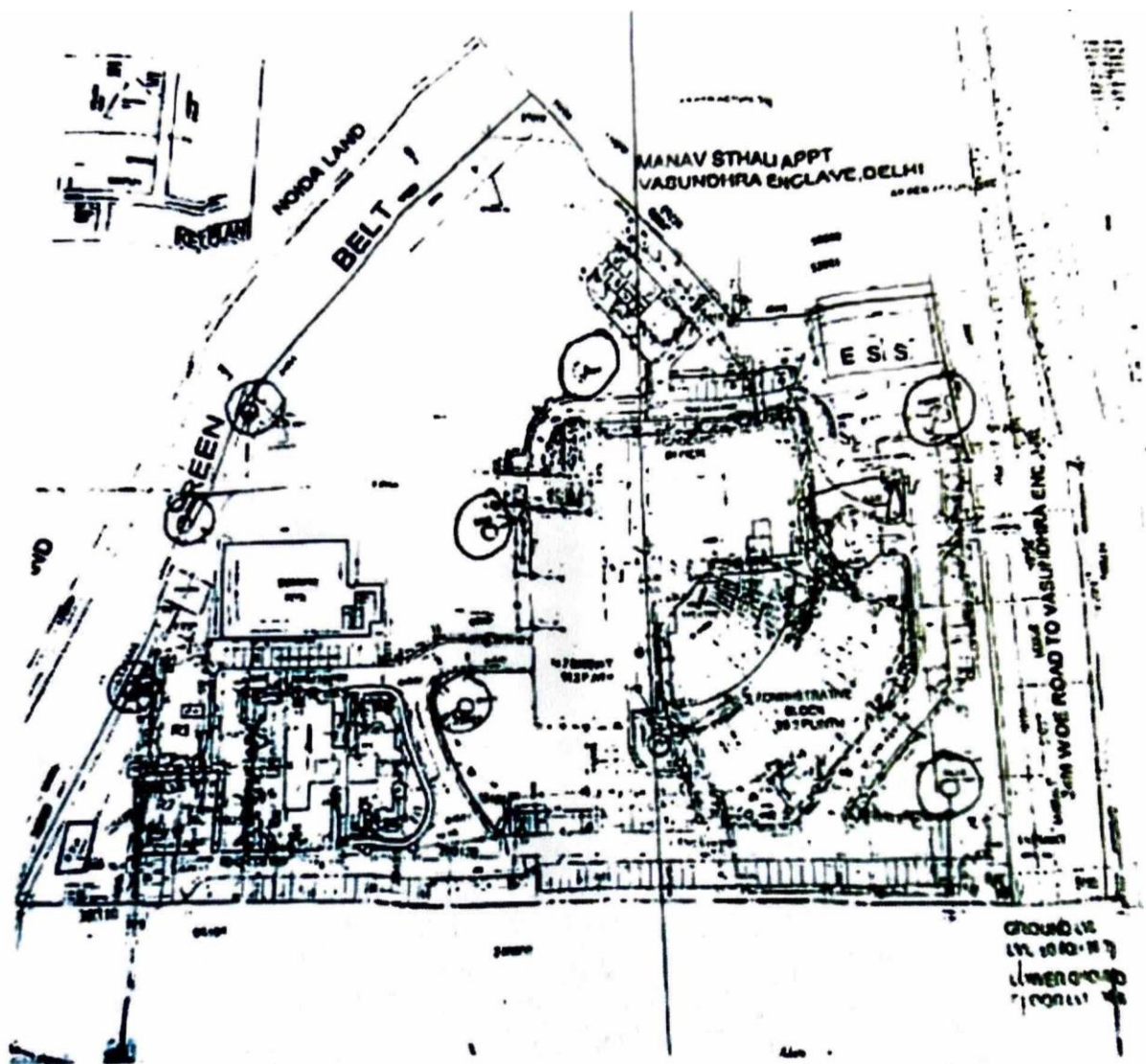

Building plan depicting rainwater harvesting points encircled in the map

Handwritten signature in green ink.



Water storage tanks

Handwritten signature in green ink.